

# ANDERSON CATTLE CO.

---

## BULL SALE



Saturday, March 28, 2015

1:00 PM

At the farm, Swan River MB

***50 TWO YEAR OLD & YEARLING***

**RED AND BLACK ANGUS BULLS**

**“RANGE READY”**

***PURCHASE YOUR NEXT HERDSIRE  
WITH CONFIDENCE***

Welcome to our sixth annual bull sale. Last year we moved the sale to the farm and we never looked back. Our program focuses on selling two year old bulls, but we are pleased to offer a select group of yearlings this year as well. We have selected for calving ease and the majority of the bulls will be recommended for heifers.

We are very excited to offer the influence of some of the most prominent programs in the breed. We selected our herdsires from several Manitoba and Saskatchewan breeders with the belief that you can shop at home. We were not disappointed and you will see this reflected in our offering.

None of our two year olds received creep feed prior to weaning. They were raised their first winter on a forage based ration. They pastured over the summer until October. A silage ration was fed with grain supplement for the remainder of the winter. All bulls receive free choice mineral.

Two year olds require plenty of room and this group of bulls are very athletic. They will go straight to work and walk your pastures with ease. All of the cattle are familiar with both horses and dogs. We work with the bulls daily and we value the good dispositions in our breeding lines.

We are offering a group of yearlings as we couldn't pass up the opportunity to add these genetics to the sale. We exhibited at Yorkton Harvest Showdown, Agritibion and Ag Days and were pleased to see that they are competitive. We hope you agree.

We can't thank our family and neighbors enough for all their extra help. A special thanks to Larry Burton and Lynne Fullerton for keeping us going, you are part of our program in so many ways. Austen and Breanna are the reason we have kept going all these years and they hold their heritage in the greatest regard. They both have excelled in the cattle industry and we couldn't be prouder.

It gives us great pleasure to see the smiles on producers faces at the auctions and we are thankful for these better times. Each producer deserves a huge thank you for keeping the beef industry alive this last decade, we certainly do.

If we or any of our sales staff can help you select a bull for your program, please call. Hope to see you March 28th!

Sincerely,

Bruce and Lone Anderson



Bruce, Lone, Breanna & Austen Anderson  
Anderson Cattle Company Inc.  
Comp 2 RR 2 Swan River MB R0L 1Z0  
204-734-2073 or 734-0730  
andersoncattle@inethome.ca

**ANDERSON CATTLE CO.  
BULL SALE**

**Saturday, March 28, 2015—1:00PM**  
**Storm date: Sunday, March 29/15**  
**listen to CKDM 730 & GX 94**

***Join us for lunch at 12 noon***

**At the farm, Swan River MB**

**Sales Staff:**

**Castlerock Marketing : Shane Castle  
(306)741-7485**

**Auctioneer: Clayton Hawreluik (306)621-3824**

**Buyer Rep: Ryan Hurlburt (306)292-9812**

**Darryl Logeot (204)522-0933**

**Darrin Bouchard (204)526-7407**

**Ring Service: Ryan Hurlburt (306)292-9812**

**Insurance: Keystone Livestock Services  
Lois McRae (204)728-3058**

**Watch for the signs!**

**From Swan River: 5 miles south Hwy 83 &  
486, 2 miles east Hwy 485, 1 mile south**

**From Kenville: 2 miles east, 2 miles north  
Hwy 486, 2 miles east Hwy 485, 1 mile  
south.**

**From Minitonas: 8 miles west Hwy 10 turn at  
Eisner Auction Sales, 5 miles south on Hwy  
488, 2 miles west Hwy 485, 1 mile south.**

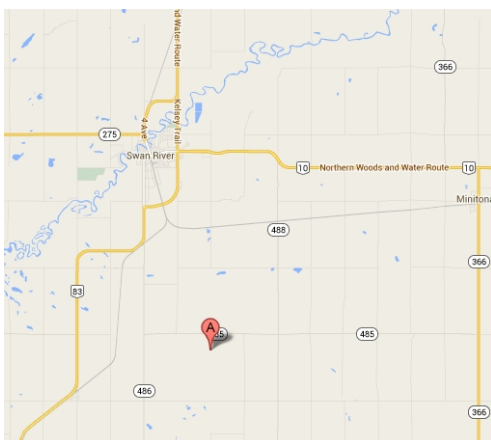

**SALE DAY PHONES:**

**(204) 734-2073 Bruce: (204)281-0851**

**Austen: (204)281-3560 Ione (204)734-0730**

**Breanna: (204)281-2174**

## ACC REFERENCE SIRES



### *CRESCENT CREEK PACESETTER 128Z*

WOS 128Z 1690713 February 27 2012 BW 88 WW 679

LOOKOUT PACESETTER 258M

**S: CRESCENT CREEK PACESETTER 16U**

CRESCENT CREEK STUMPIE 9R

GDAR GAME DAY 449

**D: GDAR BLACKCAP LADY 980**

GDAR BLACKCAP LADY 786

SPRING 2015 EPD'S BW .9 WW 33 YW 63 M 21 TM 38

30 CALVES AVG :BW 82 WW 643

We are extremely happy with the Pacesetter calves on offer. Easy fleshing, stylish individuals, both male and female. We will be keeping all of the females in our herd.



### *BROOKMORE UPWARD 116Y*

JVJ 116Y 1603884 January 31 2011 BW 88 WW 815

CONNEALY ONWARD 1273540

**S: SITZ UPWARD 307R**

SITZ HENRIETTA PRIDE 81M

BOYD BEEF MAKER 3069

**D: BROOKMORE KARAMA 105T**

BROOKMORE KARAMA 40M

SPRING 2015 EPD'S BW 1.8 WW 59 YW 117 M 31 TM 61

21 CALVES AVG :BW 82 WW 619

The Upward bulls offer lots of growth and style. He is in the top 1% of the breed for Yearling, Milk and Total Maternal EPDs. Unfortunately we only had his service for one year, so these will be the only Upward bulls we offer, don't miss out.



## *TC ABERDEEN 759*

1485453 January 27 2007

BAR EXT TRAVELER 205

**S: CRA BEXTIR 872 5205 608 AMF CAF NHF DDF**

CRA KADT HATE 608 498

BON VIEW DESIGN 036

**D: TC BLACKBIRD 4034**

TC BLACKBIRD 1013

SPRING 2015 EPD'S BW .8 WW 56 YW 101 M 31 TM 59  
704 CALVES AVG :BW 81 WW 688

We have used Aberdeen for a few years now and haven't found a better AI sire that leaves us such consistent heifer bulls. The females are moderate framed with beautiful udders. He is in the top 10 percent for BW , WW and YW and 1% for M and TM.



## *RED MCRAE'S MOHICAN 40X*

KOF 40X 1561637 January 30 2010 BW 86 WW 681

RED STEWART MR MAKER 9M

**S: RED JB MOHICAN 5001**

RED TOWAW SYBIL 135F

RED FLYING K PRINCE 171M

**D: RED MCRAE'S REBA LEE 55S**

RED MCRAE'S REBA 48L

SPRING 2015 EPD'S BW -1.24 WW 44 YW 76 TM 41  
94 CALVES AVG: BW 82 WW 624

We purchased Mohican from Mar Mac Farms in 2011. He is an excellent breeding bull, leaving dark red calves with lots of length of body. The bulls and heifers are both equally as good and we are very happy with the job he is doing at ACC.



## RED D BAR DYNAMO 67Y



LDD 67Y 1616413 March 3, 2011 BW 84 WW 793

RED FLYING K DYNAMO 67K

**S: RED U-2 DYNAMO 7021T**

RED U 2 ANEXA 549R

RED STEWART PATHFINDER 5L

**D: RED D-BAR SOXRO 28S**

RED TOP LINE SOXRO 2K

SPRING 2015 EPD'S BW 0 WW 50 YW 90 M 23 TM 48  
50 CALVES AVG : BW 84 WW 634

Darryl Elliot purchased 67Y for us at the final D Bar bull sale. We have thanked him several times. The 67Y calves are naturally thick with incredible muscle expression. He has added pounds with out increasing birth weight. He moves extremely well and has a gentle disposition. We will be using him heavily again this year.



This pair is a favorite of everyone. 13B is not impressed with her nose adornment, but we sure are. This is the second year using Quiet Weans and we will never wean any other way. The transition is seamless.



Austen and Katie on our annual cattle drive this fall. We are very excited about the upcoming nuptials this summer and even more so to add a daughter to our family.

# ACC YEARLINGS

## 1 RED ACC CURRENT TREND 11B

BIA 11B 1803807 February 03 2014  
BW:82 ADJ 205: 724

RED BRYLOR NEW TREND 22D OSF MAF  
**S: RED D-BAR CURRENT TREND 9K**  
RED PLF DUKE JOAN 3526

RED ANDERSONS CURVE BENDER 10R  
**D: RED ANDERSON'S BURTHA 36T**  
RED HFAC TIBBIE 36E

**EPDS**  
**BW** 1  
**WW** 54  
**YW** 86  
**M** 18  
**TM** 45

9K has left his mark on our herd with several females at the foundation. His son 11B proves that after twenty years New Trend 22D and 9K are still breed leaders. The strong maternal Tibbie influence makes this a very interesting combination. 9K's January 2015 EPD's BW 2.9 WW 59 YW 108 M 29 TM 58 putting him in the top 1% for milk and 3 % for YW.



## 2 RED ACC DYNAMO 7B

BIA 7B 1803806 February 01 2014  
BW:84 ADJ 205: 686

RED U-2 DYNAMO 7021T  
**S: RED D-BAR DYNAMO 67Y**  
RED D-BAR SOXRO 28S

RED ANDERSON'S DUKE 5M  
**D: RED ANDERSON'S SAM 8S**  
RED CHOPPER K SAMARIA 43K

**EPDS**  
**BW** 0.40  
**WW** 49  
**YW** 81  
**M** 17  
**TM** 42

Large and in charge describes 7B. He will make an impressive herd bull and demonstrates the performance that is becoming a trademark of Dynamo progeny. 67Y was purchased out D Bar's final bull sale and made a huge impression with his first calf crop.



# 3 *RED ACC DYNAMO 17B*

BIA 17B 1803811 February 07 2014

BW:73 ADJ 205: 761

RED U-2 DYNAMO 7021T  
**S: RED D-BAR DYNAMO 67Y**  
 RED D-BAR SOXRO 28S

RED TOWAW MATRIX 19D  
**D: RED ANDERSON'S TIBBIE 36M**  
 RED BAAC TIBBIE 1G

## EPDS

**BW** -0.59

**WW** 46

**YW** 78

**M** 24

**TM** 47

A cowmaker bull out of a long time favorite. 36M was in our herd until this fall—lots of longevity. She had many sale highlights and raised a herdsire for us. She was dark red and has left that mark on all her calves. Another strong Dynamo bull.





# 4

## RED ACC DYNAMO 35B

BIA 35B 1803818 February 17 2014

BW:83 ADJ 205: 741

RED U-2 DYNAMO 7021T

**S: RED D-BAR DYNAMO 67Y**

RED D-BAR SOXRO 28S

RED ANDERSON'S DUKE 5M

**D: RED ANDERSON'S JOANNA 82U**

RED ACF JOANNA 22M

**EPDS**

**BW** 0.20

**WW** 46

**YW** 79

**M** 16

**TM** 39

A crowd favorite at Harvest Showdown, CWA and Ag Days. Deep bodied, powerful lower quarter and wide based best describes this bull. The mother is one of our top producers, her calves averaging BW 83 and WW 673. The Joanna cow line is very strong in our herd.



# 5

## RED ACC DYNAMO 44B

BIA 44B 1803823 February 20 2014

BW:88 ADJ 205: 673

RED U-2 DYNAMO 7021T

**S: RED D-BAR DYNAMO 67Y**

RED D-BAR SOXRO 28S

RED ANDERSON'S CUB 25R

**D: RED ACC ANDERSON'S CUB 74T**

RED ANDERSON'S BONNIE 71P

**EPDS**

**BW** 0.10

**WW** 54

**YW** 89

**M** 17

**TM** 44

Lots of hip on this bull and the most hair of our yearlings. His mother has a great udder and his grand dam is still in the herd. His maternal grand sire is the D Bar Current Trend 9K bull, the sire to the Lot 1 bull.



*LOT 5*

**6** *RED ACC DYNAMO 100B*

BIA 100B 1816256 March 23 2014  
 BW:95 ADJ 205: 734

**EPDS**

**BW** 1.5

**WW** 55

**YW** 92

**M** 15

**TM** 42

RED U-2 DYNAMO 7021T

**S:** *RED D-BAR DYNAMO 67Y*

RED D-BAR SOXRO 28S

RED ANDERSON'S DUKE 5M

**D:** *RED ANDERSON'S ROXIE 46U*

RED ANDERSON'S ROXIE 15L

This bull was a favorite all summer. Although a month younger than the other bulls he has kept right up. Thick, wide based and lots of hair. His weaning ratio is 113 and will add lots of performance to your herd.



*LOT 6*

**Creating Value for Angus Tagged Cattle**



[www.rancherendorsed.com](http://www.rancherendorsed.com)

# 7

## RED ACC MOHICAN 19B

BIA 19B 1803813 February 09 2014

BW:75 ADJ 205: 635

RED JB MOHICAN 5001

**S: RED MCRAES MOHICAN 40X**

RED MCRAES REBA LEE 55S

RED ANDERSON'S DUKE 5M

**D: RED ANDERSON'S PATTIE 47S**

RED ANDERSON'S TIBBIE 87M

**EPDS**

**BW** -1.60

**WW** 42

**YW** 71

**M** 13

**TM** 34

The only Mohican yearling in the sale, but he has plenty of brothers in the two year old offering. Mohican adds length to his progeny and leaves them all dark red. Recommended for heifers.



*LOT 8*

# 8

## RED ACC PREMIER PLUS 31B

ABAA 31B 1819541 ET February 16 2014

BW:88 ADJ 205: 743

RED PREMIER PATRIOT 16

**S: RED GEIS PREMIER PLUS 72'96**

RED GEIS THELMA 169'94

RED CV FOUR TIMES

**D: RED ROBERTS KURUBA 913S**

RCN KURUBA-R 913

**EPDS**

**BW** 1.3

**WW** 33

**YW** 39

**M** 11

**TM** 28

Wes Olynyk's Christmas gift to Austen was four embryos from the GEIS Angus dispersal and this is the first calf from that mating. Dark red, thick and balanced make this time capsule a need in your bull pen.

9

**ACC DYNASTY 2B**BIA 2B 1800866 RC January 24 2014  
BW:79 ADJ 205: 600

DMM DYNASTY 03G

**S: ACN DMM DYNASTY 15J**

DMM DIAMOND MIST 8F

RED ANDERSON'S DUKE 5M

**D: RED ANDERSON'S TIBBIE 78T**

RED ANDERSON'S TIBBIE 46L

**EPDS****BW** -0.5**WW** 35**YW** 59**M** 21**TM** 39

Son of the Miller Wilson outcross bull Dynasty. He is out of one of the top cows in our herd. 78T has raised the 2014 high selling Red Angus bull and we have several females in our herd. Her male calves have a life ratio of 110 and average BW 81 and WW 610. This is an interesting pedigree.



10

**ACC KRUGERAND 12B**BAC 12B 1819603 February 03 2014  
BW:89 ADJ 205: 687

KRUGERRAND OF DONAMERE 490 AMF NHF

**S: F A R KRUGERRAND 410H AMF CAF NHF DDF**

F A R ERIANNA 286F

MOHNEN DYNAMITE 1356 AMF CAF NHF DDF

**D: PRAIRIELANE DYNA ROSEBUD 1088**

PRAIRIELANE EXTRA ROSEBUD 4044

**EPDS****BW** 3.39**WW** 54**YW** 103**M** 15**TM** 42

Breanna's first black bull on offer. She purchased Rosebud at the Prairiellane Angus dispersal. 12B is very powerfull and will make an impressive herd bull.





*LOT 10*

**11**      *ACC PACESETTER 20B*

BIA 20B 1803814 TW February 10 2014  
 BW:81 ADJ 205: 665

CRESCENT CREEK PACESETTER 16U  
**S: CRESCENT CREEK PACESETTER 128Z**  
 GDAR BLACKCAP LADY 980

ANDERSON'S CURRENT 2R  
**D: ANDERSON'S TIBBIE 35T**  
 JOST TIBBIE 4L

**EPDS**  
**BW** 3.29  
**WW** 32  
**YW** 64  
**M** 20  
**TM** 36

This is the first of the Pacesetter bulls we have on offer. He is eye catching , balanced and a tremendous cow line behind him. We purchased his sire from the 2013 Cresecent Creek Bull Sale. He possesses all of the best of his sire, disposition included. Wes displayed 16U in The Yards at CWA as a mature bull. He has such a gentle disposition and of course is out of Katie's favorite cow!



*LOT 11*



# 12

## ACC PACESETTER 23B

BIA 23B 1803815 February 13 2014

BW:73 ADJ 205: 625

CRESCENT CREEK PACESETTER 16U

**S: CRESCENT CREEK PACESETTER 128Z**

GDAR BLACKCAP LADY 980

ANDERSON'S WHO'S NEXT 39S

**D: ANDERSON'S REBA 70X**

ANDERSON'S REBA 136M

**EPDS**

**BW** 0.90

**WW** 30

**YW** 56

**M** 15

**TM** 30

Sleep easy next calving season with this heifer bull. His mother raised ACC Tiger 3Z, the service sire to all our heifers in 2013 and again in 2014. His maternal grand sire, 39S was our main herdsire for many years at ACC and left us some of the best footed cattle around. His daughters have beautiful udders.



# 13

## ACC PACESETTER 37B

BIA 37B 1803820 February 18 2014

BW:92 ADJ 205: 693

CRESCENT CREEK PACESETTER 16U

**S: CRESCENT CREEK PACESETTER 128Z**

GDAR BLACKCAP LADY 980

ANDERSON'S WHO'S NEXT 39S

**D: ANDERSON'S HOLLIE 117X**

JOST TIBBIE 12P

**EPDS**

**BW** 2.79

**WW** 42

**YW** 77

**M** 17

**TM** 38

Another strong Pacesetter bull that combines the great influence on the sire side with the proven record of the Tibbie family. Add in the Youngdale Angus influence through 39S and you can't go wrong.



**14**

**ACC PACESETTER 38B**

BIA 38B 1803941 February 18 2014

BW:87 ADJ 205: 704

CRESCENT CREEK PACESETTER 16U

**S: CRESCENT CREEK PACESETTER 128Z**

GDAR BLACKCAP LADY 980

ANDERSON'S WHO'S NEXT 39S

**D: ANDERSON'S BONNIE 87W**

RED ANDERSON'S BONNIE 22T

**EPDS**

**BW** 2.7

**WW** 39

**YW** 69

**M** 19

**TM** 39

Another strong Pacesetter son out of one of our top 39S daughters. His maternal grand dam, 22T was designated a Premier female in 2014. All of the Pacesetter bulls are easy fleshing and easy moving.



# 15

## ACC PACESETTER 73B

BIA 73B 1812516 March 10 2014  
BW:86 ADJ 205: 738

CRESCENT CREEK PACESETTER 16U  
**S: CRESCENT CREEK PACESETTER 128Z**  
GDAR BLACKCAP LADY 980  
  
HF TIGER 5T AMF CAF NHF OSF DDF  
**D: ACC DAISY 8Z**  
ANDERSON'S BRENNA 0122X

**EPDS**  
**BW** 3.5  
**WW** 47  
**YW** 82  
**M** 23  
**TM** 47

Daisies have a special place in Bruce's heart and that isn't because it is lone's favorite flower! The original Daisy cow came out of a country wide trip looking for the perfect heifer calf in 1985, finding her at Double Bar, Illinois US. Keeping her genetics frozen for nearly a decade she once again has an intergral place in our operation. Tremendous combination.



# 16

## ACC KODIAK 64B

BIA 64B 1812511 RC March 07 2014  
BW:86 ADJ 205: 759

SOO LINE KODIAK 8158  
**S: KEMBAR KODIAK 10Y**  
KEMBAR BANDOLIER LASS 72U  
  
ANDERSON'S NEXT GENERATION 20U  
**D: RED ACC TIBBIE 80Z**  
ANDERSON'S TIBBIE 12X

**EPDS**  
**BW** 3.60  
**WW** 70  
**YW** 118  
**M** 19  
**TM** 54

We purchased 10Y from Kembar Farms in 2012, selected for his calving ease and picture perfect mother. He had a WW ratio of 116 and his calves have averaged BW 81 and WW 677. His spring 2015 EPD's are BW .6 WW 50 YW 86 M 21 TM 46. He has a brother in the two year old offering, but you will have to wait to next year to see more. Don't miss this opportunity.

## ACC TWO YEAR OLDS

# 17 RED ACC MOHICAN 30A

BIA 30A 1735168 February 26 2013  
BW:87 ADJ 205: 635

### EPDS

**BW** 0.1  
**WW** 46  
**YW** 81  
**M** 19  
**TM** 42

RED JB MOHICAN 5001

**S: RED MCRAES MOHICAN 40X**

RED MCRAES REBA LEE 55S

RED D-BAR CURRENT TREND 9K

**D: RED ANDERSON'S BONNIE 71P**

RED FBAC BONNIE 6F MAF

What a bull to start off the two year old offering. This is the type that will cover a lot of cows and leave some excellent replacement females. He is long like his sire and profiles beautifully. His mother is a proven producer and still in the herd. Her male calves have a 124 YW ratio.



# 18 RED ACC MOHICAN 40A

BIA 40A 1735175 March 07 2013  
BW:85 ADJ 205: 677

### EPDS

**BW** -0.29  
**WW** 48  
**YW** 74  
**M** 18  
**TM** 42

RED JB MOHICAN 5001

**S: RED MCRAES MOHICAN 40X**

RED MCRAES REBA LEE 55S

RED ANDERSONS CURVE BENDER 10R

**D: RED ANDERSON'S VALENTINE 69U**

RED ANDERSON'S VALENTINE 10M

The picture on the next page says it all. His profile and eye appeal abounds. 69U has raised many sale toppers and has a smoking Mohican heifer calf in our keeper pen. Her calves have averaged BW 84 and WW 663.



19

**ACC MOHICAN 49A**

BIA 49A 1735181 RC March 11 2013  
 BW:86 ADJ 205: 530

**EPDS**

**BW** 0.80  
**WW** 45  
**YW** 76  
**M** 19  
**TM** 42

RED JB MOHICAN 5001

**S: RED MCRAES MOHICAN 40X**

RED MCRAES REBA LEE 55S

RED ANDERSON'S CURVE 85T

**D: ANDERSON'S DUCHESS 93X**

ANDERSON'S DUCHESS TIBBIE 79U

Another Mohican son from a cow that is proving to be a strong cow. She has a heifer calf in the keeper pen and her first calf produced a ACC Tiger 3Z bull calf that will be in the sale offering next year.

20

**RED ACC MOHICAN 65A**

BIA 65A 1735191 March 16 2013  
 BW:78 ADJ 205: 502

**EPDS**

**BW** -0.90  
**WW** 38  
**YW** 58  
**M** 16  
**TM** 35

RED JB MOHICAN 5001

**S: RED MCRAES MOHICAN 40X**

RED MCRAES REBA LEE 55S

RED ANDERSONS CURVE BENDER 10R

**D: RED ANDERSON'S VALENTINE 70W**

RED ANDERSON'S VALENTINE 31H

This bull is tough as nails, born on the wrong side of the ranch on a -30 morning! He is an easy fleshing and has a great temperament. Recommended for heifers.





**21**      **ACC MOHICAN 70A**

BIA 70A 1735196 RC March 17 2013

BW:89 ADJ 205: 535

RED JB MOHICAN 5001

**S: RED MCRAES MOHICAN 40X**

RED MCRAES REBA LEE 55S

ANDERSON'S WHO'S NEXT 39S

**D: ANDERSON'S MATTIE 93W**

RED ANDERSON'S MATTIE 7S

**EPDS**

**BW** -1

**WW** 41

**YW** 73

**M** 18

**TM** 39

A Mohican son with the 39S influence on his maternal side. 39S was the most consistent herdsire to walk at ACC. He sired 173 calves in his time at ACC and we have many females in the herd, wishing we had more. Neat udders and a perfect foot every time.



# 22 *RED ACC MOHICAN 86A*

BIA 86A 1735208 March 21 2013

BW:90 ADJ 205: 574

## EPDS

**BW** -0.5

**WW** 42

**YW** 72

**M** 23

**TM** 44

RED JB MOHICAN 5001

**S:** *RED MCRAES MOHICAN 40X*

RED MCRAES REBA LEE 55S

RED D-BAR CURRENT TREND 9K

**D:** *RED ANDERSON'S VALENTINE 56P*

RED ANDERSON'S VALENTINE 12F

A very thick easy fleshing herd bull backed by a prolific dam that is in the herd today. The 9K influence is reflected her, his daughters are terrific producers. Everyone loves a valentine and you will find several throughout this book.



# 23 *RED ACC MOHICAN 93A*

BIA 93A 1735213 March 25 2013

BW:90 ADJ 205: 531

## EPDS

**BW** -0.59

**WW** 43

**YW** 76

**M** 18

**TM** 39

RED JB MOHICAN 5001

**S:** *RED MCRAES MOHICAN 40X*

RED MCRAES REBA LEE 55S

RED ANDERSON'S DUKE 5M

**D:** *RED ANDERSON'S VALENTINE 88W*

RED ANDERSON'S VALENTINE 24M

One of the first bulls you notice in the pen, he is a favorite of visitors and one of the most powerfull bulls on offer. Mohican will be on display and you will not be disappointed by the length and volume he possesses. The 5M influence can be found many of our foundation females, siring 145 head during his time at ACC.



## 24 *RED ACC MOHICAN 94A*

BIA 94A 1735214 March 25 2013  
 BW:85 ADJ 205: 689

RED JB MOHICAN 5001  
**S: RED MCRAES MOHICAN 40X**  
 RED MCRAES REBA LEE 55S

RED GEIS PREMIER PLUS 72'96  
**D: RED ANDERSON'S PRIMULA 64N**  
 RED ANDERSON'S TIBBIE 72G

**EPDS**  
**BW** 0.29  
**WW** 49  
**YW** 75  
**M** 17  
**TM** 41

64N was one of Breanna's 4-H projects. Her male calves have a weaning index of 107. This bull will add frame and eye appeal to your calves. His maternal grand sire is the sire of Lot 8.

## 25 *RED ACC MOHICAN 98A*

BIA 98A 1735218 March 27 2013  
 BW:86 ADJ 205: 580

RED JB MOHICAN 5001  
**S: RED MCRAES MOHICAN 40X**  
 RED MCRAES REBA LEE 55S

RED BIEBER CHIEFTON 3080  
**D: RED YY URRISAL 107L**  
 RED LADY BERNICE DEVOLANE 7A

**EPDS**  
**BW** 0  
**WW** 53  
**YW** 88  
**M** 12  
**TM** 39

98A was raised by a cow that just left our herd this fall. Ione had a list of the oldest females in the herd and Bruce wasn't allowed to argue. Her calves averaged BW 78 and WW 616. Looking for a heifer bull, here he is.

# 26 *RED ACC MOHICAN 105A*

BIA 105A cm3376430 March 31 2013  
BW:88 ADJ 205: 507

RED JB MOHICAN 5001  
**S: RED MCRAES MOHICAN 40X**  
RED MCRAES REBA LEE 55S

RED D-BAR CURRENT TREND 9K  
**D: RED ANDERSON'S MARIA 65N**  
RED ACF MARY 7E

**EPDS**  
**BW** 0  
**WW** 47  
**YW** 78  
**M** 19  
**TM** 43

This bull is very balanced and has a great profile, as do all the Mohicans. His mother is sired by the 9K bull that has influenced our herd. Her daughters averaged a WW ratio of 121. This bull is recorded as a commercial animal, however a registration paper will be provided at sale time.



# 27 *RED ACC MOHICAN 107A*

BIA 107A 1735223 April 01 2013  
BW:71 ADJ 205: 626

RED JB MOHICAN 5001  
**S: RED MCRAES MOHICAN 40X**  
RED MCRAES REBA LEE 55S

RED ANDERSON'S DUKE 5M  
**D: RED ANDERSON'S BONITA 67R MAF**  
RED FBAC BONITA 49F

**EPDS**  
**BW** -0.10  
**WW** 50  
**YW** 85  
**M** 20  
**TM** 45

A Mohican son recommended for heifers. Note the 5M influence on the maternal side. His dam has life averages for WW and YW at 114 and 113 respectively.

# 28 *RED ACC MOHICAN 109A*

BIA 109A 1735224 April 02 2013  
BW:76 ADJ 205: 500

RED JB MOHICAN 5001  
**S: RED MCRAES MOHICAN 40X**  
RED MCRAES REBA LEE 55S

RED ANDERSON'S DUKE 5M  
**D: RED ANDERSON'S CADILLINA 124W**  
RED ANDERSON'S TIBBIE 17R

**EPDS**  
**BW** -1.1  
**WW** 36  
**YW** 63  
**M** 20  
**TM** 38

A great combination with Mohican, Tibbie and Duke. Recommended for heifers.

# 29 *RED ACC MOHICAN 120A*

BIA 120A 1735232 April 18 2013  
BW:78 ADJ 205: 544

RED JB MOHICAN 5001  
**S: RED MCRAES MOHICAN 40X**  
RED MCRAES REBA LEE 55S

ANDERSON'S BLACK DUKE 5U  
**D: RED ANDERSON'S TIBBIE 4X**  
RED FBAC TIBBIE BTR 7G

**EPDS**  
**BW** -0.5  
**WW** 45  
**YW** 74  
**M** 12  
**TM** 35

120A is one of the younger bulls in the Two Year Old pen. His maternal grandsire was a favorite of Bruce's and sold to Wes Hofford in one of our first sales. He did a great job for Wes. Recommended for heifers.





# 30

## RED ACC DYNAMO 88A

BIA 88A 1735209 March 23 2013  
BW:83 ADJ 205: 586

RED U-2 DYNAMO 7021T  
**S: RED D-BAR DYNAMO 67Y**  
RED D-BAR SOXRO 28S

RED BECKTON LANCER F442 T OSF MAF  
**D: RED ANDERSON'S TIBBIE 87M**  
RED BAAC TIBBIE 1G

**EPDS**  
**BW** 0.29  
**WW** 53  
**YW** 85  
**M** 13  
**TM** 40

We are very excited to offer our first Dynamo two year olds. You won't be disappointed. The natural muscle expression his offspring is impressive. His first daughters are calving at ACC and we are very happy. 88A offers the strength of the Tibbie family as well.



# 31

## RED ACC DYNAMO 91A

BIA 91A 1735183 March 13 2013  
BW:72 ADJ 205: 500

RED U-2 DYNAMO 7021T  
**S: RED D-BAR DYNAMO 67Y**  
RED D-BAR SOXRO 28S

ANDERSON'S NEXT GENERATION 20U  
**D: RED ANDERSON'S ROXIE 79Y**  
RED ANDERSON'S ROXIE 15L

**EPDS**  
**BW** -0.29  
**WW** 46  
**YW** 80  
**M** 17  
**TM** 40

Deep flanked and thick this bull will breed heifers or cows. His mother is the perfect Angus cow with a beautiful udder. The Roxie cow line comes from D Bar—no surprise here as Darryl and Diane made a huge impact on the Red Angus breed.



# 32 *RED ACC DYNAMO 95A*

BIA 95A 1735217 March 26 2013

BW:88 ADJ 205: 629

RED U-2 DYNAMO 7021T  
**S: RED D-BAR DYNAMO 67Y**  
RED D-BAR SOXRO 28S

RED CHOPPER K CADILLAC 352N  
**D: RED ANDERSON'S TIBBIE 17R**  
RED ANDERSON'S TIBBIE 100M

## EPDS

**BW** 1.1

**WW** 49

**YW** 81

**M** 23

**TM** 48

95a is big hipped and his mother was a very powerful cow, coming from the Tibbie line that has shaped our herd. His grand dam was a foundation female and has a 2015 Milk EPD of 31.



# 33

## RED ACC DYNAMO 101A

BIA 101A 1735219 March 28 2013

BW:83 ADJ 205: 603

RED U-2 DYNAMO 7021T

**S: RED D-BAR DYNAMO 67Y**

RED D-BAR SOXRO 28S

RED ANDERSONS CURVE BENDER 10R

**D: RED ANDERSON'S SAM 51U**

RED HFAC TIBBIE 28L

### EPDS

**BW** 0.69

**WW** 54

**YW** 86

**M** 15

**TM** 42

Mom was on fire with the camera picture day and caught 101A looking mighty fine! He has the most hip of the two year olds. 10R once again goes back to D Bar and left us lots of thickness in his offspring. 51U calves have a YW ratio of 114 and averaged BW 81 and WW 618



# 34

## RED ACC DYNAMO 131A

BIA 131A 1735241 May 27 2013

BW:79

RED U-2 DYNAMO 7021T

**S: RED D-BAR DYNAMO 67Y**

RED D-BAR SOXRO 28S

ANDERSON'S NEXT GENERATION 20U

**D: RED ANDERSON'S SIERRA 96Y**

RED ANDERSON'S SIERRA 87N

### EPDS

**BW** 0.29

**WW** 50

**YW** 87

**M** 22

**TM** 46

One of the youngest two year olds in the pen. If you are looking for calving ease and to add milk to your herd he will. The Sierra line are great milkers and 87N is still in the herd. The 20U females are true gems.



“Hank” is the newest staff member at ACC and comes to us from Justabouta Ranch, Hanley SK. His mentor “Tuff” is still our main hired man, but is getting close to retirement. We’d be lost without them.



**35**

**RED ACC BIG SKY 121A**

BAC 121A 1747210 April 16 2013  
BW:77

RED BIEBER MAKE MIMI 7249 OSF MAF  
**S: RED FEDDES BIG SKY R9 OSF MAF**  
RED FEDDES LAKINA 310 OSF

ANDERSON'S NEXT GENERATION 20U  
**D: RED ANDERSON'S TIBBIE 32Y**  
RED ANDERSON'S BIEBE 8T

**EPDS**  
**BW** -1.39  
**WW** 56  
**YW** 85  
**M** 21  
**TM** 49

One of Breanna’s bulls, he is dark red. His grand dam, 8T was one of her 4-h projects and was so quiet she has become quite a pest. Once again the Tibbie and 20U influence will prove a great addition. Recommend on heifers.

**36**

**RED ACC MR BEEF 3089A**

BIA 3089A 175960 ET July 02 2013  
BW:89

RED HLH BUSTER 406 603 OSF MAF  
**S: RED BADLANDS MR BEEF 805 OSF MAF**  
RED BADLANDS KEEPSAKE 632

RED RIDGE LANE LANCER 43G  
**D: RED ANDERSON'S TIBBIE 15J**  
RED FBAC TIBBIE PAT 10G

This long yearling is a result of embryos in storage for several years. His mother 15J had a picture perfect udder and sold in the 2001 Manitoba Magic sale for \$12,500. Her calves averaged BW 83 and WW 612.





**37**

**ACC UPWARD 38A**

BIA 38A 1735174 March 06 2013

BW:72 ADJ 205: 556

SITZ UPWARD 307R DMF AMF CAF NHF DDF

**S: BROOKMORE UPWARD 116Y**

BROOKMORE KARAMA 105T AMF

TC ABERDEEN 759 AMF CAF NHF DDF

**D: ANDERSON'S JOANNA 7Y**

ANDERSON'S JOANNA 43W

**EPDS**

**BW** 0.80

**WW** 52

**YW** 100

**M** 25

**TM** 51

This performance bull has a pedigree deep in breed leaders. He is very thick and easy fleshing. The Upward cattle need no introduction and the combination of Aberdeen will give you the option of using this bull on cows or heifers.

**38**

**ACC UPWARD 39A**

ABAA 39A 1737422 March 06 2013

BW:85 ADJ 205: 729

SITZ UPWARD 307R DMF AMF CAF NHF DDF

**S: BROOKMORE UPWARD 116Y**

BROOKMORE KARAMA 105T AMF

TC ABERDEEN 759 AMF CAF NHF DDF

**D: ANDERSON'S TIBBIE 8Y**

ANDERSON'S TIBBIE 105W

**EPDS**

**BW** 2.70

**WW** 56

**YW** 103

**M** 28

**TM** 56

This big boy is Austen's most powerful two year old. Lots of performance here, this bull will cover a lot of cows. He is in the top 10% of the breed for WW, YW and M.



# 39

## ACC UPWARD 53A

BIA 53A 1747209 March 13 2013

BW:86 ADJ 205: 629

SITZ UPWARD 307R DMF AMF CAF NHF DDF

**S: BROOKMORE UPWARD 116Y**

BROOKMORE KARAMA 105T AMF

ANDERSON'S NEXT GENERATION 20U

**D: ANDERSON'S VALENTINE 64Y**

RED ANDERSON'S VALENTINE 56P

**EPDS**

**BW** 3.29

**WW** 51

**YW** 94

**M** 25

**TM** 51

Lots of style in this Upward son to go with his breed leading performance. The Valentine line needs no introduction and will add milk production to your females. His WW ratio is 112.



# 40

## ACC UPWARD 58A

BIA 58A 1735188 March 14 2013

BW:87 ADJ 205: 594

SITZ UPWARD 307R DMF AMF CAF NHF DDF

**S: BROOKMORE UPWARD 116Y**

BROOKMORE KARAMA 105T AMF

ANDERSON'S WHO'S NEXT 39S

**D: ANDERSON'S HEATHER 21W**

RED ANDERSON'S HEATHER 64K

**EPDS**

**BW** 3.10

**WW** 53

**YW** 99

**M** 23

**TM** 50

Turn the page and take a look at his picture ... no further explanation needed. A cow bull from the very productive Heather line. His mother is a very powerful cow.



**41**

**ACC UPWARD 59A**

BIA 59A 1735185 March 14 2013

BW:77 ADJ 205: 582

SITZ UPWARD 307R DMF AMF CAF NHF DDF

**S: BROOKMORE UPWARD 116Y**

BROOKMORE KARAMA 105T AMF

TC ABERDEEN 759 AMF CAF NHF DDF

**D: ANDERSON'S HEATHER 3Y**

ANDERSON'S HEATHER 21W

**EPDS**

**BW** 2.6

**WW** 55

**YW** 103

**M** 26

**TM** 54

Another Upward son from the Heather cow line. 3Y has a Pacesetter bull calf in the pen that will be in the two year old offering next year. His picture illustrates the eye appeal and completeness of this package.



42

*ACC UPWARD 61A*

BIA 61A 1735187 March 14 2013  
BW:77 ADJ 205: 501

SITZ UPWARD 307R DMF AMF CAF NHF DDF

**S: BROOKMORE UPWARD 116Y**  
BROOKMORE KARAMA 105T AMF

ANDERSON'S WHO'S NEXT 39S

**D: ANDERSON'S MARIA 105X**  
RED ANDERSON'S MARIA 65N

**EPDS**

**BW** 2  
**WW** 49  
**YW** 92  
**M** 20  
**TM** 45

These will be the only Upward bulls for offer at ACC as we only had the service of 116Y for one season. This bull is recommended for heifers.



*LOT 43*

43

*ACC UPWARD 78A*

BIA 78A 1735202 March 19 2013  
BW:70 ADJ 205: 593

SITZ UPWARD 307R DMF AMF CAF NHF DDF

**S: BROOKMORE UPWARD 116Y**  
BROOKMORE KARAMA 105T AMF

TC ABERDEEN 759 AMF CAF NHF DDF

**D: ANDERSON'S DAISY 14Y**  
ANDERSON'S BREANNA 106W

**EPDS**

**BW** 0.69  
**WW** 52  
**YW** 99  
**M** 27  
**TM** 53

Another Upward from the Daisy cow line, a favorite of Bruce's . He is recommended for heifers.

# 44

## ACC UPWARD 99A

ABAA 99A 1760609 RC March 28 2013

BW:88 ADJ 205: 683

SITZ UPWARD 307R DMF AMF CAF NHF DDF

**S: SFL UP TOP 42Y**

MISS WIX 301 OF MC CUMBER

RED CRESCENT CREEK PROSPECTOR

**D: RED CRESCENT CREEK ANNIE 137W**

RED CRESCENT CREEK ANNIE 15T

**EPDS**

**BW** -1.2

**WW** 62

**YW** 97

**M** 20

**TM** 51

A heifer bull out of Austen's first of many Crescent Creek acquisitions—Katie being the best by far! The CCA Annie cow line is well recognized within the Red Angus breed. We are having a hard time letting him go.



# 45

## ACC ABERDEEN 36A

BIA 36A 1735171 March 04 2013

BW:83 ADJ 205: 553

C R A BEXTOR 872 5205 608 AMF CAF NHF DDF

**S: TC ABERDEEN 759 AMF CAF NHF DDF**

TC BLACKBIRD 4034 CAF

ANDERSON'S WHO'S NEXT 39S

**D: ANDERSON'S SUSAN 66Y**

RED ANDERSON'S SUSAN 84M

**EPDS**

**BW** 2.7

**WW** 45

**YW** 86

**M** 22

**TM** 45

We are always looking for that sire that will leave heifer bulls without giving up performance. Aberdeen has proven to be one of those sires. Recommended for heifers.

# 46

## ACC ABERDEEN 52A

ABAA 52A 1737424 March 12 2013

BW:71 ADJ 205: 588

C R A BEXTOR 872 5205 608 AMF CAF NHF DDF

**S: TC ABERDEEN 759 AMF CAF NHF DDF**

TC BLACKBIRD 4034 CAF

F A R KRUGERRAND 410H AMF CAF NHF DDF

**D: ANDERSON'S TIBBIE 4Y**

ANDERSON'S TIBBIE 2W

**EPDS**

**BW** 1.60

**WW** 53

**YW** 96

**M** 22

**TM** 49

Austen's Tibbie 4Y has a Pacesetter bull in the pen that will be offered in next years sale as another heifer bull. She has averaged BW 77 WW 636. A pedigree deep in breed greats, this bull will make next calving season a relaxing one.

# 47

## ACC ABERDEEN 84A

ABAA 84A 1755984 RC March 21 2013

BW:78 ADJ 205: 523

C R A BEXTOR 872 5205 608 AMF CAF NHF DDF

**S: TC ABERDEEN 759 AMF CAF NHF DDF**

TC BLACKBIRD 4034 CAF

RED D-BAR TREND 1M

**D: RED CRESCENT CREEK ANNIE 84R**

RED CRESCENT CREEK ANNIE 85J

**EPDS**

**BW** -1.8

**WW** 50

**YW** 83

**M** 26

**TM** 51

A combination of the CCA Annie line and D Bar Current Trend (a 9K son) will add great maternal traits to your herd. Recommended on heifers.



**LOT 47**



# 48

## ACC ABERDEEN 51A

BIA 51A 1735182 RC March 12 2013  
BW:78

TC ABERDEEN 759 AMF CAF NHF DDF  
**S: ANDERSON'S ABERDEEN 11Y**  
ANDERSON'S VALENTINE 12W

RED ANDERSON'S DUKE 5M  
**D: RED ANDERSON'S TIBBIE 14X**  
RED BAAC TIBBIE 8F

**EPDS**  
**BW** -1.10  
**WW** 44  
**YW** 76  
**M** 23  
**TM** 45

11Y was an Aberdeen son that we used for one season. He passed on the traits of his sire to his sons. Recommended for heifers.

# 49

## ACC ABERDEEN 64A

BIA 64A 1735190 RC March 16 2013  
BW:83 ADJ 205: 597

TC ABERDEEN 759 AMF CAF NHF DDF  
**S: ANDERSON'S ABERDEEN 11Y**  
ANDERSON'S VALENTINE 12W

RED ANDERSONS CURVE BENDER 10R  
**D: RED ANDERSON'S TIBBIE 15X**  
RED BAAC TIBBIE 1G

**EPDS**  
**BW** 0.40  
**WW** 55  
**YW** 85  
**M** 18  
**TM** 45

Another 11Y son that combines Aberdeen and Tibbie breeding. Recommended for heifers.



# 50 ACC ABERDEEN 76A

BIA 76A 1735199 March 18 2013

BW:86 ADJ 205: 641

C R A BEXTOR 872 5205 608 AMF CAF NHF DDF  
**S: TC ABERDEEN 759 AMF CAF NHF DDF**  
TC BLACKBIRD 4034 CAF

ANDERSON'S WHO'S NEXT 39S  
**D: ANDERSON'S BONITA 72Y**  
RED ANDERSON'S BONNIE 71P

**EPDS**  
**BW** 3.79  
**WW** 52  
**YW** 92  
**M** 23  
**TM** 49

Profiled below, this Aberdeen son has lots of style. He is easy fleshing and recommended for heifers.



# 51 ACC ABERDEEN 113A

BIA 113A 1735226 April 09 2013

BW:74 ADJ 205: 621

TC ABERDEEN 759 AMF CAF NHF DDF  
**S: ANDERSON'S ABERDEEN 11Y**  
ANDERSON'S VALENTINE 12W

RED ANDERSON'S DUKE 5M  
**D: ANDERSON'S TIBBIE 128W**  
JOST TIBBIE 12P

**EPDS**  
**BW** 0  
**WW** 48  
**YW** 86  
**M** 17  
**TM** 41

The last of the Aberdeen sons on offer, 113A combines the Tibbie . 128W calves averaged BW 82 and WW 651. He is recommended for heifers.

**ANGUS Tags ...**  
*Be a part of the Endorsement!*

• **Marketing Opportunities**  
 • **Free Third Party Age Verification**  
 • **Delivery Right to Your Door**

**ANGUS**  
 CANADIAN ANGLUS ASSOCIATION  
 Canadian Angus Association  
 142, 6715 - 8 Street NE • Calgary, AB T2E 7H7  
 1-888-571-3580 • cdnangus@cdnangus.ca  
 www.cdnangus.ca

You Tube B f

Grant Dakston

All buyers will be entered into a draw for a complimentary bag of "Green Tags". These are the dangle tag and RFID combination and will be registered to your farm following the sale. All ACC cattle are tagged with Angus tags. We strongly believe in the program and would like to pass the benefits on to you.

**52**

**ACC CREED 31A**

BIA 31A 1735169 February 27 2013  
 BW:77 ADJ 205: 520

GUMBO GULCH CREED 94S AMF CAF NHF MAF DDF  
**S: DMM CREED 75W AMF CAF NHF OSF MAF DDF**  
 RED DMM ESSENCE 156P

DUNLOUISE EXCALIBUR Y070 CAF DDF  
**D: ANDERSON'S BRENNIA 5X**  
 ANDERSON'S BRENNIA 110N

**EPDS**  
**BW** 2.79  
**WW** 37  
**YW** 63  
**M** 15  
**TM** 34

A very interesting Creed heifer bull sired by the 2011 Northland Supreme Champion and 2011 Angus Show Bull of the Year. A paternal sister is designated to our show string this fall.



# 53

## ACC WHO'S NEXT 90A

BIA 90A 1735211 RC March 24 2013

BW:77 ADJ 205: 503

YOUNG DALE WHO'S NEXT 92N

**S: ANDERSON'S WHO'S NEXT 39S**

JOST TIBBIE 4L

RED ANDERSON'S DUKE 5M

**D: RED ANDERSON'S VALENTINE 51W**

RED ANDERSON'S VALENTINE 12F

**EPDS**

**BW** -0.20

**WW** 37

**YW** 62

**M** 14

**TM** 33

This is the last 39S bull to be offered at ACC. We can't say enough about the impact his sire had on our program. The Youngdale influence can be seen throughout the herd. He walked our pastures for 7 years and left the ranch as an athletic and sound bull. Don't miss a chance to own these genetics.



# 54

## ACC KODIAK 73A

BIA 73A 1735193 March 17 2013

BW:77 ADJ 205: 629

SOO LINE KODIAK 8158

**S: KEMBAR KODIAK 10Y**

KEMBAR BANDOLIER LASS 72U

ANDERSON'S NEXT GENERATION 20U

**D: ANDERSON'S TIBBIE 53Y**

RED ANDERSON'S TIBBIE 78T

**EPDS**

**BW** 1

**WW** 46

**YW** 77

**M** 20

**TM** 43

The only Kodiak two year old offered this year, 73A promises to be a great addition to your herd. Offering calving ease with performance his sire had a WW ratio of 116 and calves averaged BW 81 WW 677. He is a paternal brother to Lot 16 in our yearling offering. His mother is the picture of a perfect Angus cow with a beautiful udder.



*If it takes a community to raise a child then it takes an army to have a bull sale! We can't thank those listed below enough for your contribution to our program. From making feed, to moving and feeding cows, to working the sale you are all so very important to our operation and to each of us.*

Our families, Katie Olynyk, Larry Burton, Lynne Fullerton, Barker Family, Big Bend Simmentals, Shaw Farms, Green Valley Stock Farm, TKO Custom Spraying, Galbraith Electric, Swan Valley Vet Clinic, Sean Barker, our entire sale staff, Lynne Stehr, Tanya Staniland, Kassi Highmoor, Corey Barker, Gerrad Wenzel, Katie Jo Stehr, Wade Olynyk, Kodie Doetzel, Blair Barker, Nathan Barker, Traci Henderson, Verneece Eggie, Grandma Donna, Lynne Wenzel, Ian Down, Ron Galbraith, Angela Mullin, Barb Lewis and anyone else we have missed!



***Spruce Products Ltd.***



Lumber Manufacturer in the Swan River Valley since 1942  
Swan River MB ~ (204)734-3089 ~ [www.spl.mb.ca](http://www.spl.mb.ca)

Rough, S4S and treated lumber available. Custom bundles of boards for portable wind panels available.

If you need anything for your fencing or construction projects give us a call.

***Roblin Forest Products***

**Swan Wood Shavings Inc.**

Bagged Wood Shavings  
Animal Bedding  
Swan River MB  
(204) 734-7800

Large inventory of posts, poles and more. Pressure treating since 1958.  
Roblin MB 1-877-937-2103  
[rfp@mts.net](mailto:rfp@mts.net)  
[www.roblinforestproducts.com](http://www.roblinforestproducts.com)



**Terms:** The terms of the sale are cash or cheque, payable in Canadian Funds. The right of property shall not pass until after the settlement has been made; no invoicing on buyers in attendance unless previous arrangements have been made. Every animal sells to the highest bidder and in cases of disputes, the auctioneers decision will be final. Announcements from the auction block take precedence over the printed matter in the catalogue.

**Cattle Inspection:** All carry permanent identity tags, corresponding to Sale Lot Numbers as well as Canadian Cattle Identification Tags.

**Health:** The bulls offered for the sale have been vaccinated in June and October for IBR, PI-3, BRSV, 8 WAY BLACK LEG, HEAMOPHILUS, SOMNUS AND PASTERURELLA HAEMOLYTICA. All bulls were treated for external and internal parasites.

**Breeding Guarantee:** All cattle are sound and right, and sell with a responsible breeder guarantee of satisfaction. In the event of an unlikely dispute, the regular terms and conditions of the Canadian Angus Association shall apply. All bulls will be semen tested and breeding soundness evaluated by a licensed veterinarian.

**Phone or Mail Bids:** If you are unable to attend sale day, you can entrust your bid in confidence to sales staff or the consignors.

**Insurance:** The animals become the responsibility of the purchaser after the animal is sold. Insurance will be available on sale day. We strongly recommend you insure your purchase.

**Liabilities:** All persons attend the sale at their own risk. The seller, facility owner and sale staff assume no liability, legal or otherwise for any accidents that occur.

**Delivery:** The two year old bulls will be delivered as soon as possible after the sale. Please speak to us about arranging delivery or deduct \$50 from the purchase price if you take your bull home sale day. Any bulls remaining at the farm must be insured and after May 1/15 will be kept at a cost of \$3/day.

***All bulls in the sale offering will be vet inspected and have passed a semen test prior to the sale. Scrotal measurements, tests results and current weights will be available at the sale.***

Anderson Cattle Company Inc. uses Canadian Angus Performance Program (CAPP) whole herd reporting and performance data is printed in the catalogue.



***SIGHT UNSEEN PURCHASE PLAN— Call us to discuss your specific needs. Your satisfaction guaranteed.***



***2014  
Sale  
Crew  
Thanks!***